



Product Knowledge Guide



appliancePro
get the best from your appliances

JUNE 2018

Control your air conditioner from anywhere, anytime.

(Plus so much, much more...)







SENSIBO SKY

Make your air conditioner smart



WHAT SENSIBO SKY DOES.

-  **Saves energy, lower bills!**
-  Monitors temperature and humidity remotely.
-  Easy 7 day scheduling.
-  Automatically turn on or off based on your location.
- ☒ Connect to Google Home, Alexa and IFTTT.

WHAT YOU NEED.

- ☒ WiFi, with internet connection.
- ☒ A smart phone, (iphone/android).
- ☒ Any infrared remote controlled air conditioner.



works with the
Google Assistant

"smart, and has already saved me energy..."
"at last I can arrive home to comfort..."

**AT
LAST**

A great retro-fit and add-on
for **air conditioners**



Works with ANY infrared remote Air conditioner – Even a 35 year old one



Model: Sensibo Sky



Product knowledge Guide Contents

- About
- Features
- Marketing
- Reviews
- Connecting
- FAQ's

Sensibo
explained!
who buys?
latest tech tests
Sensibo to other devices
Set Up
Compatibility
Physical unit
Using
Support

- Specifications



SENSIBO

The ultimate DIY device to control your Air conditioner

appliancePro & Jalmac Sales & marketing are proud to announce their appointment as exclusive supplier of the ground breaking Sensibo Sky product in New Zealand.

There is no competition! Sensibo Sky is the only product available from New Zealand retailers that can provide add-on WiFi control, climate react & Geo-Fencing for existing Air conditioners

An amazing add-on for new Air conditioner sales and a **real opportunity for the** 19,000,000 + remote controlled split system Air conditioners already in Australian homes & business's



FASTCOMPANY

TC TechCrunch

THE VERGE

|||obleizer

GADGET REVIEW

Übergizmo

What is Sensibo Sky?

Sensibo Sky is the ultimate DIY device to control any infrared remote controlled Air conditioner, from *anywhere* and make it smart. With Sensibo Sky you will be able to control, monitor, automate and save energy. In one app control many devices, and share your devices with your family at home and colleagues at work.

Simply; it's the biggest break-through in
Air conditioner technology in 25 years

It's a retro-fit for any of the estimated 19,000,000 split systems already installed in Australia

How does Sensibo Sky work?



Just leaving work, open app & turn your Air conditioner **on**

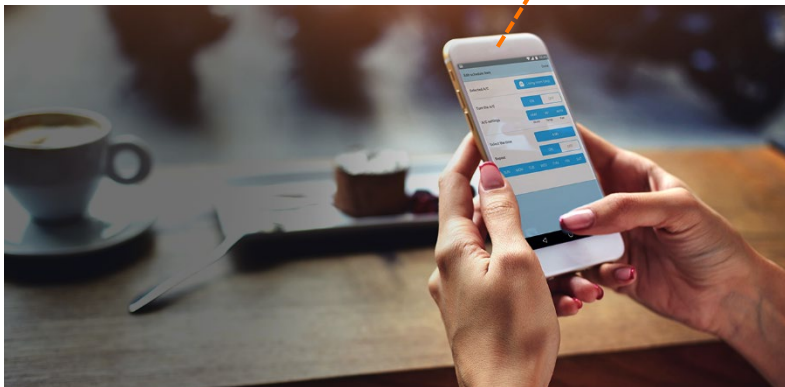

Back at home the **on** command is transferred via WiFi to Sensibo Sky, which sends an infrared signal to the Air conditioner and it turns **on ... instantly!**



i In this example we have just turned the unit on, we can also tell it what temperature, fan speed, vane action and function we want. There is also information going the reverse way, the Sensibo Sky unit sends current room temperature and humidity reading back to the app



Main Features Explained

Key Sensibo Sky features

Works with *any* infrared remote controlled Air conditioner.



Control your Air conditioner from anywhere.

Turn your Air conditioner on or off, change mode, fan speed and swing from anywhere



Voice Control– Amazon Alexa & Google Home compatible!

Pair with either in minutes and enjoy handy voice control and monitoring



Monitor temperature and humidity

Know the climate in your space from anywhere



Create 7 day schedules.

Easy set up with *unlimited* scheduling. Best scheduling ability available in the market today

Key Sensibo Sky features



Geofencing – trigger air conditioner to turn on and off based on your location

So clever! turns on when you approach, off when you leave. Accommodates multiple users



Climate React – trigger automatic response to your room conditions

Set your Sensibo to react to room temperature eg: If room rises above 32° turn on A/C to 25° cooling



PC Control – complete control and logs on any PC or Mac

Full control, monitoring and graphical logs from a PC or Mac



Filter reminder – optimise running costs by keeping filters clean

Sensibo monitors running time and reminds you when it's time to clean the filters



Save energy - lower power bills

Better control means less waste and lower bills

What does a customer need to use Sensibo Sky?

There are a few essentials:



WiFi network (with internet connection)

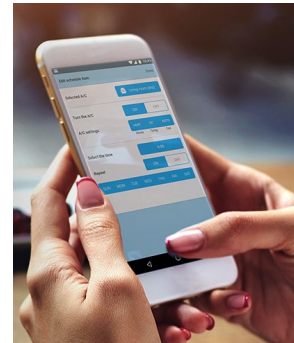

Sensibo App (free Download)



Smart Phone (iPhone or Android)



Any remote controlled Air conditioner*

* If remote is not working there is a simple work around during set-up

Super easy guided set up!

Just follow the instructions in the app

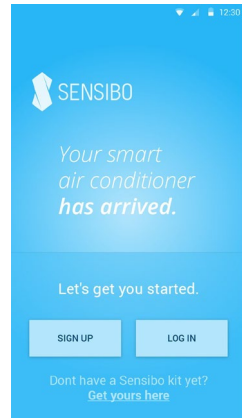

Download the app

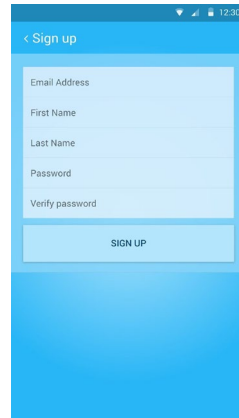

Sign up

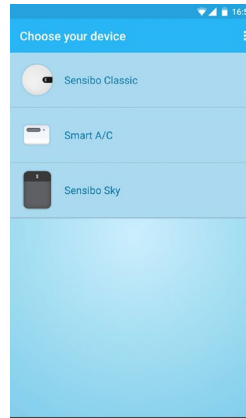

Choose Sensibo Sky

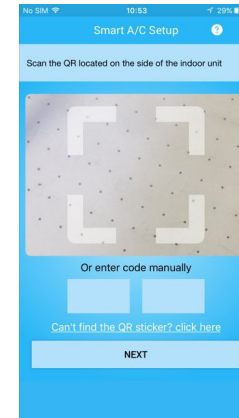

Take a pic of the QR code on your Sky unit (or input number)

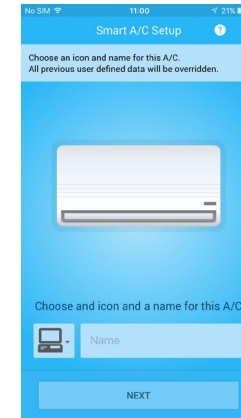

Choose a name for your AC – eg: LG Bedroom

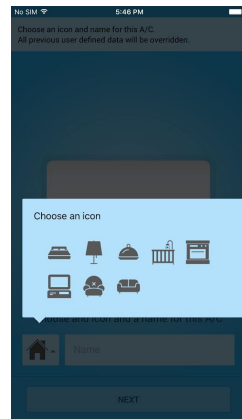

Choose a icon for your A/C



Now pair to your WiFi

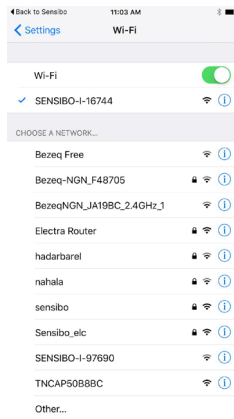

Choose your WiFi

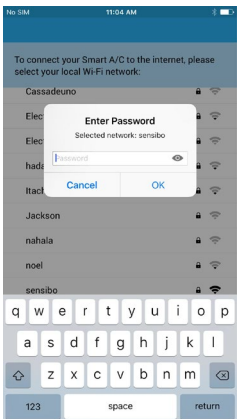

Enter your WiFi password

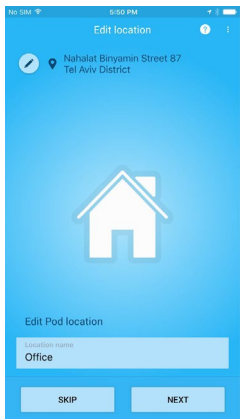

Name your location eg: Home.

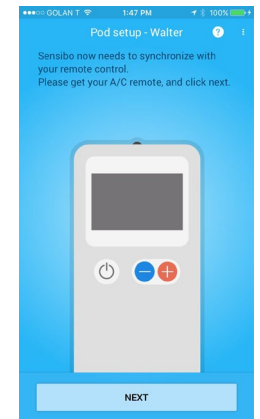

Point and press the on button from your existing remote

Super easy control from *anywhere*

Main control Screen

Current temperature & humidity in the room

Temperature up

Select fan speed

Select function (auto, heat, cool, dry or fan)

Functions

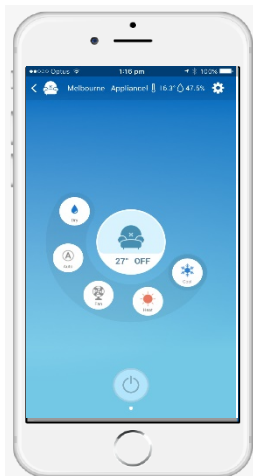

Vane control

On / Off Timer key

Temperature down

Power key

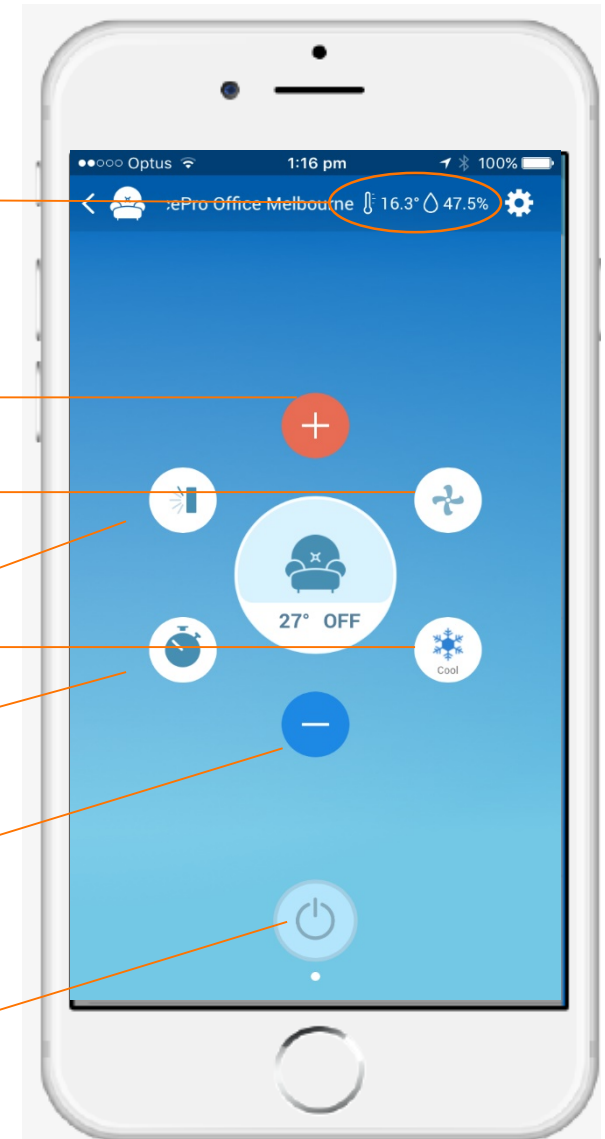

Super easy tools menu

Access via  symbol on main screen

Shows log of events eg: the temperature was set to 25°C

Set your climate react thresholds here

if app says on but unit is off

To change Sensibo to different Air conditioner

Great feature!!! Save running costs by always cleaning filters

Share with family, friends & colleagues by text or email

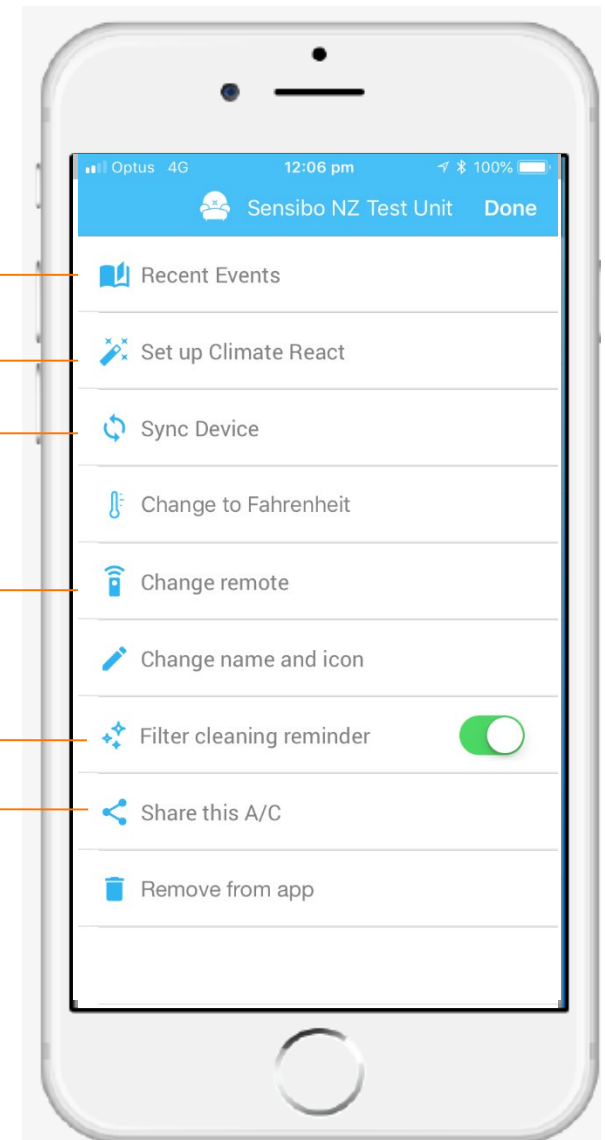

What is Sensibo Geofencing?

Easiest to show you this feature with a screenshot from the Sensibo app, showing our Melbourne office test unit.

This is the fence!

Just move the slider to increase or decrease the fence distance around your house.

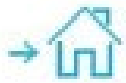

When I enter into the set fence area – A/C automatically turns on



When I exit the set fence area – A/C turns off



I don't want to Geofence!!
– easy just click disable and manually control your unit from anywhere

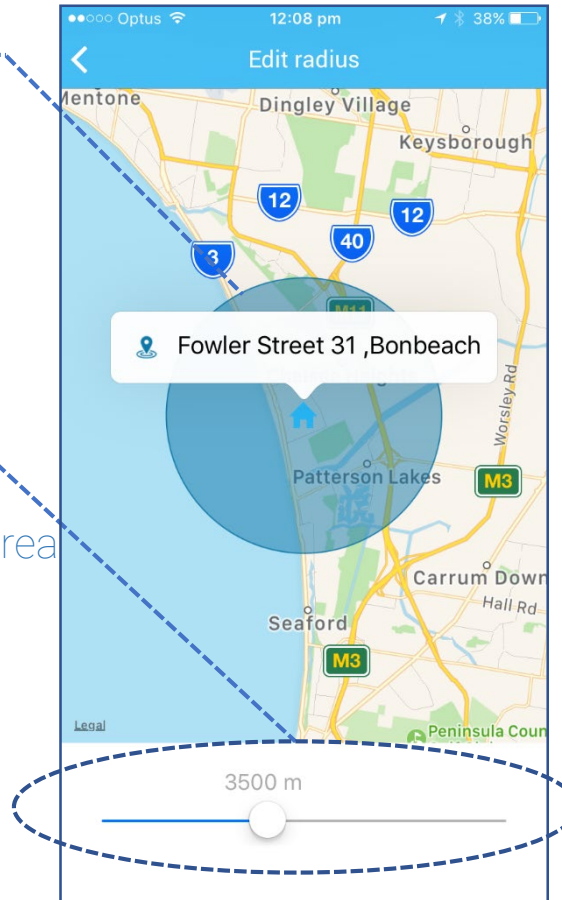

Real life example!



John here works in Hobart city, he leaves the office around 6pm every day, except for Wednesday and Friday (footy practice):

John has set a geo-fence of 7Km around his house.

No matter what time John gets home he **always** comes back to a heated living room because his Air conditioner turned on as soon as he crossed into his geofence.

Bonus! John no longer forgets to turn his Air conditioner off in the morning, his Air conditioner automatically turns off when he crosses over his geofence, this has saved John a lot of money)

But there's more than one person in my house??? – easy – you can have multiple users, as many as you like, who ever leaves the fence last automatically turns the AC off, who ever enters the fence first turns it on

new

Climate *react mode*



Let your A/C automatically react to room temperature changes

The Climate React feature allows your Sensibo Sky to monitor and automatically react to changes in room temperature. The user sets pre-defined trigger temperatures and sets the desired response to those changes

For example, you can have Sensibo Sky start up to cool at 25° if the room temperature gets above 30°

Or

Start to heat at 22° if the room temperature drops below 15°



How it works

- 1 Set the temp that you want to react to. (Eg: 30°)
- 2 Tell Sensibo what to do when the trigger temp is reached.

Set up Climate React (beta) for AppliancePro Office Melbourne

0° 19° 25° 60°

1

When temperature goes below 19° then

Set AC State to ▾

Heat to 22° medium

2

When temperature goes above 25° then

Set AC State to ▾

Cool to 22° medium

CANCEL APPLY

Great for elderly folks, pets, computer rooms, hot nights, cold mornings and lots more!

new Climate *react* mode

Phone interface

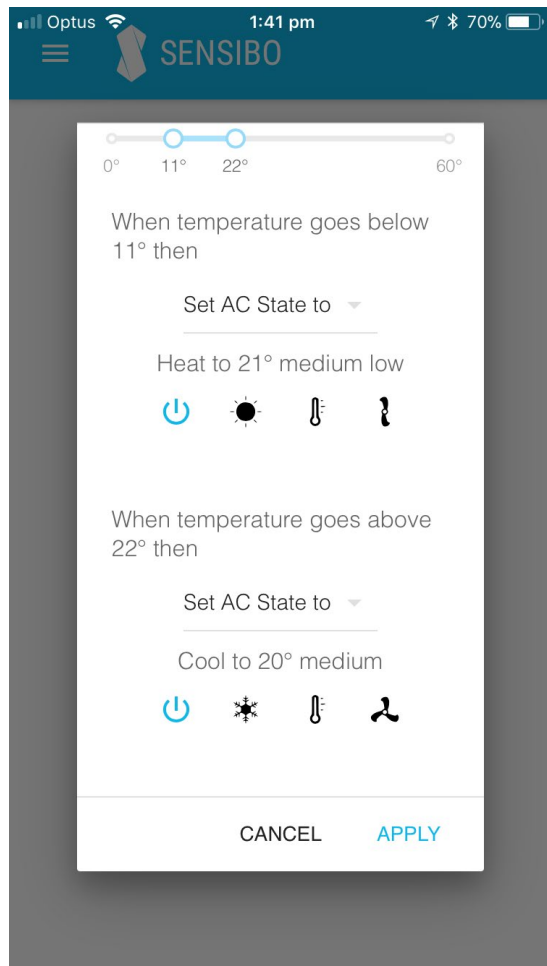

Climate *react*- Set up screen
Yep – super easy again

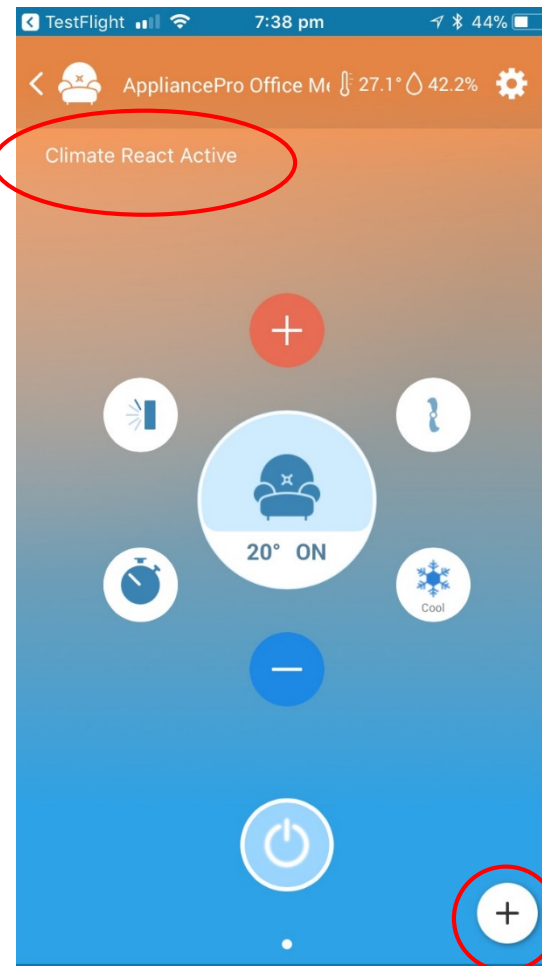

Shows Climate React Active
New add button allows easy
access to

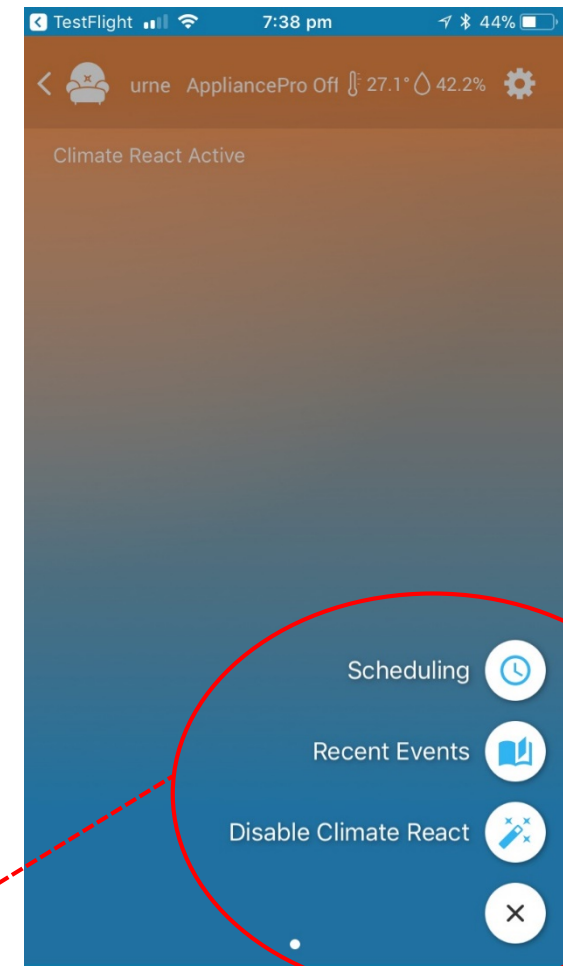

These features

Super easy timer.

Use as an on or off timer

In this example the Air conditioner is on and will turn off in 20 minutes

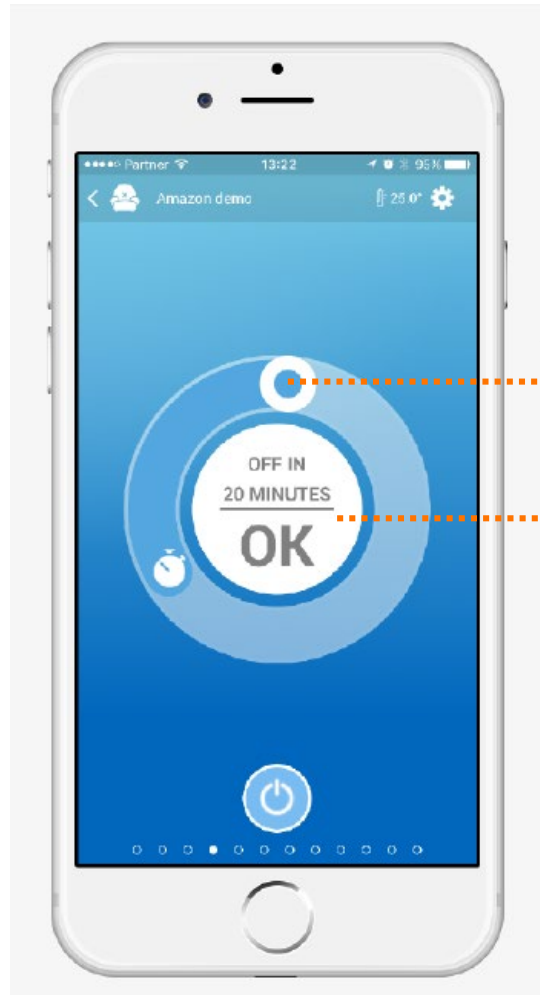

How to use:

Press the timer icon on the main screen

Just slide clockwise to increase time or anti-clockwise to decrease

Then tap "OK"

Yes that easy! How long would this take to do on a normal remote?

Super easy scheduling

7 day scheduling

In this example the Air conditioner will turn on and cool to 22° C, high fan speed at 5:05pm

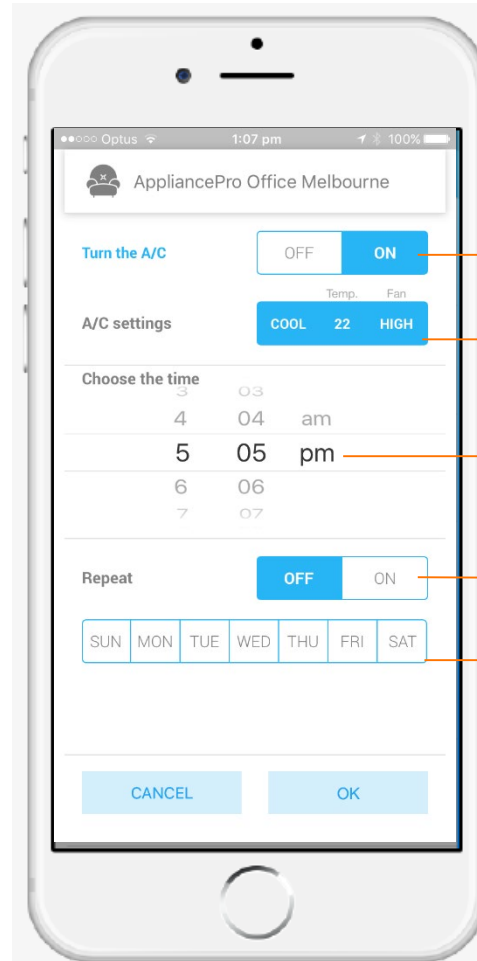

How to use:

Select the action; turn on or turn off

Choose function, temp and fan speed

What time do you want it to happen?

Do you want it to happen again?

When do you want it to happen again? Choose 1 or more days

Q. How long would this take to do on a normal remote? – A: you can't do this on a normal remote. It's an awesome Sensibo feature

Super easy 7 day scheduling

Real life example!

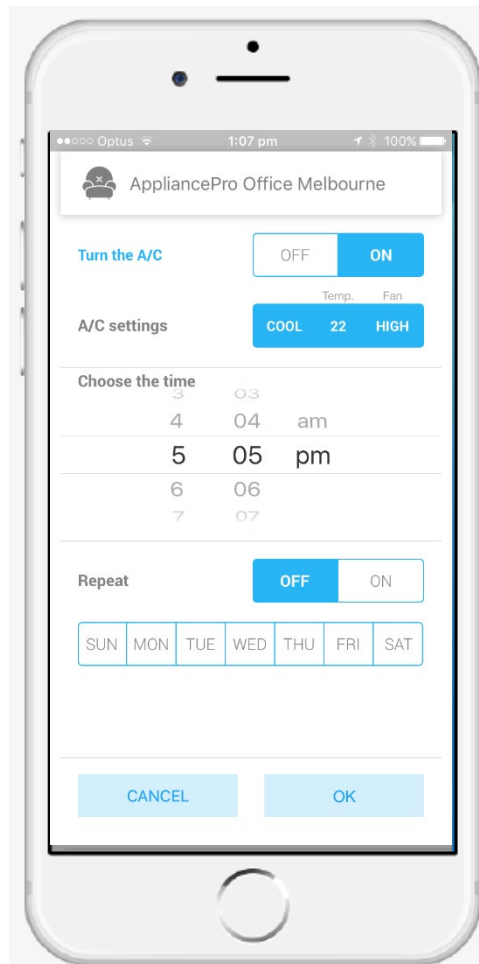

Sensibo Sky **saves him money** and assures his staff and customers the ultimate comfort.



Marty here owns a café called McFly's, it's located in Cairns and the opening hours are:

Mon – Thur:	7.30am – 5.00pm
Friday:	7.30pm – 9.00pm
Sat:	9.00am – 5.00pm
Sun:	10.00am – 4.00pm

He has one large split system in the main dining area paired with his Sensibo Sky.

It took Marty about **2 minutes** to set the Air conditioner schedule to suit his opening times. He starts it 15 minutes before opening so that it's at temperature when staff and customers arrive

Marty tried to do this on his old remote but it won't cater for the different hours on different days.
Sensibo saves him money and assures comfort without having to lift a finger

Sensibo Setting Tip

Never leave your Air conditioner on **again, ever.**

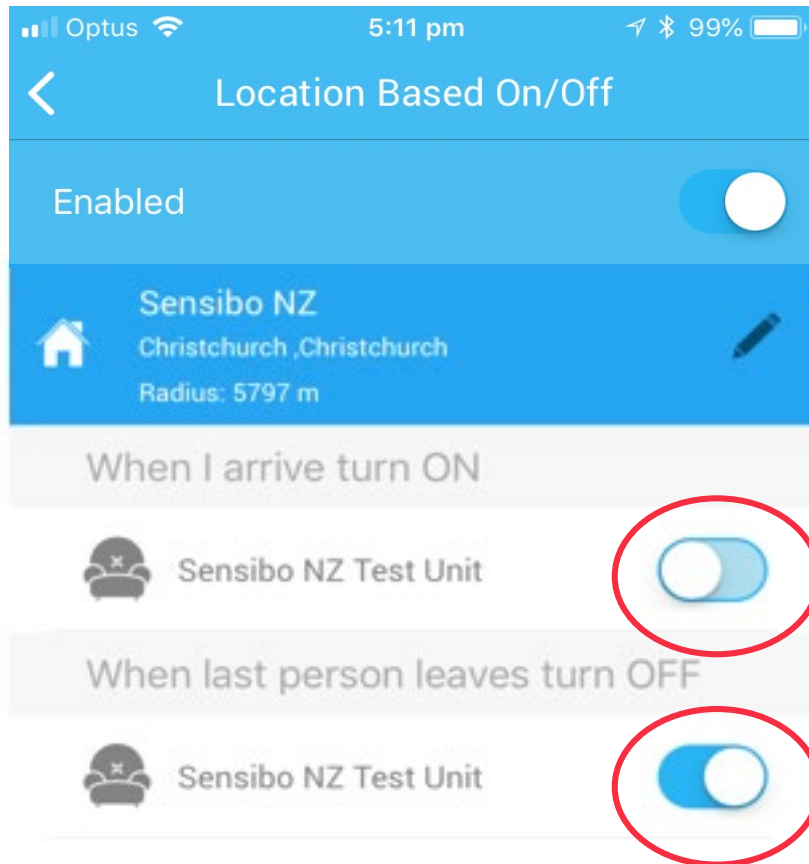

Set & forget:

The last person to exit your set geofence will **always** activate the unit to turn off

Slide this setting to "Off"

Slide this setting to 'on'

Control from PC (or MAC)

Full control and monitoring is also available from any PC or MAC:
New feature

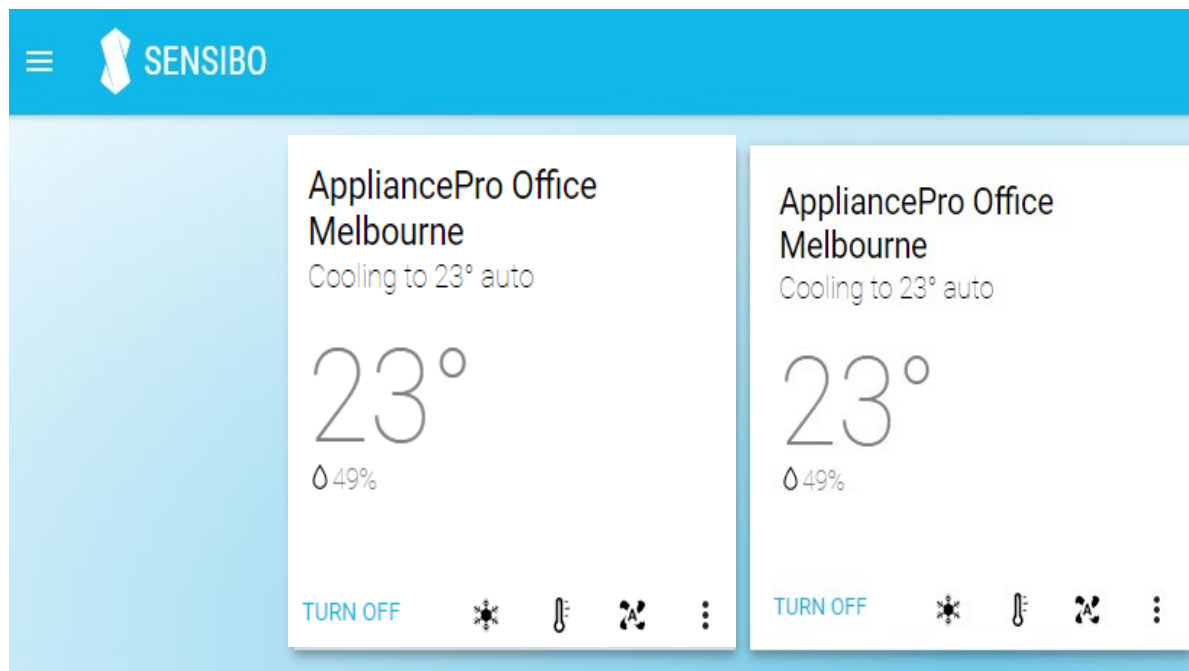

How to use:

Just type in [Https:// home.Sensibo.com](https://home.Sensibo.com)

Yes – that's it!
Sensibo = Easy!!

View log of temperature,
humidity and events

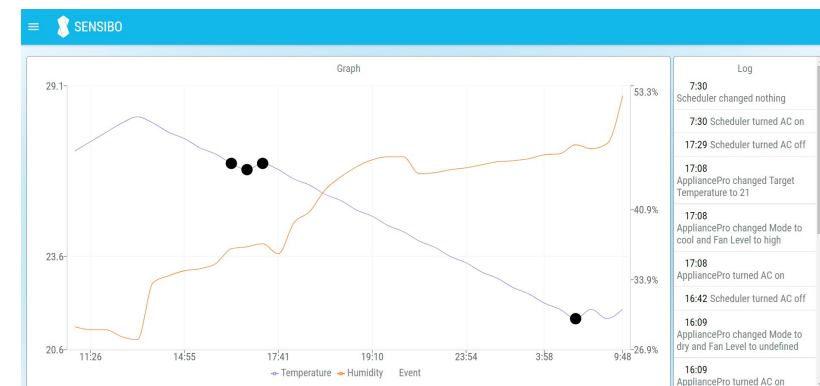

Super easy energy saving



Save energy, lower power bills

How does Sensibo save *you* money?

No need to run your Air conditioner all day.

You set the off timer so you don't forget to turn off

You are running late so turn your Air conditioner off

Remotely adjust your A/C to a more economical temperature

Use the scheduler so it only runs when you need it to

You react to a cool change and turn your A/C off

You run out the door & forget to turn your Air conditioner off

You only turn on just before arriving

And lots more



Marketing Sensibo Sky

Commercial / project **use examples**



Bank of units in a **school** with Sensibo Sky

- Automatically schedule turn on at 8.15am weekdays
- Automatically schedule turn off at 4.30pm weekdays
- Manually control each unit from PC in school office
- Filter clean reminder for each unit



Bank of units in a **motel** with Sensibo Sky

- Manually control each unit from PC in reception.
- Turn on when guest checks in
- Turn off when guest checks out or leaves
- Filter clean reminder for each unit



Bank of units in **aged care** with Sensibo Sky

- Manually control each unit from PC in reception.
- Climate react triggers for low room temperature
- Climate react triggers for high room temperature
- Filter clean reminder for each unit



Connectivity to other Devices

Make your Air conditioner smarter-er

Sensibo is natively compatible with leading domestic home automation platforms:

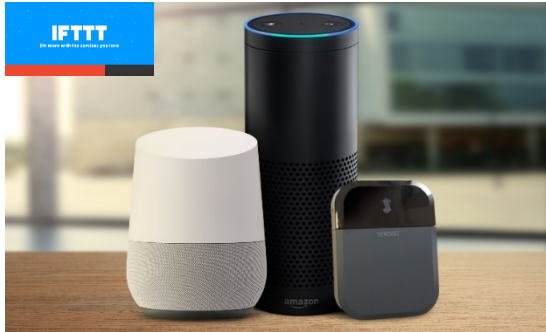

Google Home
Google assistant
Amazon Alexa
IFTTT

Sensibo is compatible with leading home automation hubs:



SmartThings (3rd party)
Control4
RTI
HomeAssistant (3rd Party)

Sensibo is compatible with leading home automation software:

OpenHab (3rd Party)
iRidium (3rd Party)

Support for all hub & software integrations is available from Facebook Sensibo users

Compatibility – Amazon Alexa

Sensibo is native to Alexa, sign in to Alexa, go to smart home and enable Sensibo skill. Then ask Alexa to 'discover devices' and it will pair automatically. It takes less than a minute to pair.



Voice Commands ('Alexa ...')

Turn on Living Room

Turn off Living Room

Set temperature in Living Room to 25 degrees

Increase temperature in Living Room (by X degrees)

Decrease temperature in Living Room (by X degrees)

What is Living Room set to?

What is the temperature in the Living Room?

Compatibility – Google Home (Google Assistant)

Sensibo is native to Google home, just select Sensibo from a list of home devices and use your Sensibo sign-in credentials to pair and get started. It takes less than a minute to pair.



Voice Commands (Ok Google ...)

Ok Google, turn on the living room
Ok Google, turn on the thermostat
Ok Google, turn off the bedroom
Ok Google, turn off the thermostat
Hey Google, increase the temperature in the bedroom
Ok Google, set the temperature in the bedroom to 25°
Ok Google, set living room to cooling
Ok Google, set thermostat to cooling
Ok Google, set living room to heating
Ok Google, set thermostat in living room to heating
Hey Google, what is the living room set to?
Hey Google, what is the temperature in the living room?
Ok Google, what is the humidity in the living room? (if applicable)

Tip! Even if you don't have a Google Home device you can download Google assistant app for free add Sensibo and ask simple things like 'what's the temperature in the living room?'

Compatibility – IFTTT

Sensibo is native to IFTTT, sign in to free IFTTT app and select Sensibo, sign in and you are paired. It takes less than a minute to pair. IFTTT is free.



Recipe

if this then that

Trigger

Action

If This Then That

Simple, effective (and free!) home automation is possible using what IFTTT call 'applets'.

IFTTT allows triggering of one smart event based on another.

For example:

- If the front door smart lock is locked turn Sensibo off.
- If smart pet door opens turn Sensibo on to cool to 22°C
- If garage door opens turn on Sensibo to heat to 21°C
- If outside humidity is above 55% turn on Sensibo to dry mode

Any IFTTT compatible device can be used to trigger another and it's a big list of products and brands.

Compatibility – Control4, RTI

Control4 & RTI are market leading high end home automation systems which are used to integrate complete home living solutions, garage doors, watering systems, lighting, blinds, air conditioning, plus audio and visual components are most common. These systems use tablets switches & voice control.



All Sensibo needs is a driver

Drivers have been developed for Sensibo and are available from <https://www.chowmainsoft.com>



There are a vast number of authorised Control4 & RTI installers in New Zealand



Sensibo Sky in Review

Sensibo Sky in review



Trevor Long (Australia's leading tech reviewer)

 **EFTM**
January 24 · 🌐

This may be the coolest smart home gadget you can get! This simple little [Sensibo](#) controls your EXISTING air conditioner (split-system or portable) via your smartphone app - and it can be programmed based on time and your location too! Sensational idea, and works so easily!



[Sensibo](#) Review: Makes your old "dumb" split system super smart! » EFTM

This simple little device turns any remote controlled air conditioner smart by connecting to wifi and giving you app based control no matter where you are!

EFTM.COM.AU

“Honestly, I have no hesitation in recommending this unit for anyone who has an interest in smart home products, app control and power savings”

5/5 Stars

<https://eftm.com/2018/01/sensibo-review-makes-your-old-dumb-split-system-super-smart-46648>



Sensibo Sky in review



"Sensibo is a device that promises to do one thing, smarten your air conditioners (or is that thermostats?). From where I stand they not only deliver on that but have made some wise decisions that make their smart integrations easy to use"

<https://ausdroid.net/2018/03/03/control-your-air-conditioner-via-google-assistant-or-alexa-thanks-to-sensibo-sky-australian-review/#comments>



"Easy, cheap way to add automation features to your air conditioning"

<http://www.afr.com/technology/sensibo-sky-review-a-most-unamerican-nest-thermostat-20180107-h0ekq2>



"Sensibo Sky does a great job at turning a regular device like an air conditioner into a smart device to open it up and make you easier and more convenient to use"

<http://www.techguide.com.au/reviews/sensibo-sky-review-turn-air-conditioner-smart-device/>



(Australian customer reviews)



RobOftheHills

Belair, South Australia

Reviews **2**
Votes **10**

Age **25 to 34**

Gender **Male**

★★★★★ · 3 months ago

Great bit of kit!

I bought this only last week and it's fantastic! So easy to set up and even easier to operate! I love the "Climate React" function, where Sensibo turns on the AC when the room reaches the temperature you set it to! Highly recommended

Quality of Product



Value of Product



DarrelIV

Melbourne, Vic

Review **1**
Vote **1**

Age **35 to 44**

Gender **Male**

★★★★★ · 3 months ago

Works Well, Very Happy with this product!

The Sensibo phone app works well and the automatic (beta) Climate React feature is also works very well.. I hope Sensibo bring HomeKit compatibility soon but works very well "as is" using the App.

Quality of Product



Value of Product



<https://www.harveynorman.com.au/sensibo-sky-wifi-air-conditioner-controller.html>



Frequently asked Questions

Frequently asked questions – Set Up



What do I need to set up Sensibo Sky?

You need a smart phone, a Wi-Fi network connected to the internet plus a working infrared remote controlled air conditioner.

I have 3 Air conditioners do I need 3 Sensibo sky's?

Yes – you need one for every individual unit.

How long does it take to set up?

It takes about five minutes

Which air conditioners brands does Sensibo Sky work with?

Any, as long as they have an infrared remote control: works any ceiling unit, portable, split system and window wall

Do I need a remote to be able to set up my Sensibo?

No, it is easier if you have the remote but there is a work around if you don't. It will take a little longer to set up without the remote.

Where's the best place to position the Sensibo Sky unit?

You need line of sight to your air conditioner, best is side-on so it can adjust status from signal from your normal remote, front or even below your AC works well. Sensibo has a range of 6m

Frequently asked questions – Compatibility



Will Sensibo Sky control my ducted Air conditioner? Evaporative Cooling?

No – it works infrared controlled systems only. It will not work with evaporative cooling systems even if they do use a remote control as the features and functions are different.

Can I control my Sensibo Sky from a PC?

Yes, just log in at [HTTPS://home.sensibo.com](https://home.sensibo.com) and your unit(s) are there awaiting your command

What smart home systems will Sensibo Sky connect to?

Sensibo will connect to Google Home through the Google Assistant, Amazon Alexa, Apple homeKit (via HomeBridge), IFTTT (If this then that), SmartThings (unofficial), OpenHab (unofficial), iRidium (unofficial) Home assistant (unofficial), RTI & Control4

What are the native Google Home commands:

Ok Google, turn on the living room

Ok Google, turn off the bedroom

Hey Google, increase the temperature in the bedroom

Ok Google, set the temperature in the bedroom to 25 degrees

Ok Google, set living room to cooling

Ok Google, set living room to heating

Hey Google, what is the living room set to?

Hey Google, what is the temperature in the living room?

Ok Google, what is the humidity in the living room? (if applicable)

Frequently asked questions – Compatibility



What WiFi will Sensibo Sky connect to?

Sensibo is compatible with b/g/n. It does not support 5GHz network (just choose the normal network provided by all 5GHz routers)

Frequently asked questions – in use

How do I know I have crossed in or out of my Geofence?

A notification is sent to your phone for example: "Steve's living room is now on"

What Air conditioner functions can I control?

Heating, Auto, dehumidify, fan-only and cooling, fan speed, vane action and position on timer and off timer + 7 day unlimited schedule

What setting comes on when I enter my Geofence?

The last setting used by the air conditioner, of course the settings can be changed as per normal set up operation

Does the Geofence allow me to only turn my Air conditioner on?

Yes, you can choose only to turn on when entering your fence, only turn off when you exit or both.

How many Air conditioners can I have on my app?

There is no limit you can have as many as you like and control each one individually across multiple locations as well

Frequently asked questions – in use



How do I share my Sensibo Sky device with other family and friends?

Easy, your family just download the free app, sign up, then simply open “settings” click “Share this A/C” and send an invite via email, text, whatsapp, messenger etc The receiver just opens the message and the A/C automatically becomes available to them to control.

Can I see the temperature in the room remotely?

Yes, you can also see the temperature and humidity in the room from your phone or from a PC anywhere.

Both are measured at the Sensibo Sky unit, not at the air conditioner.

This is a great feature if the weather changes and you want to react to that change. Your pets will enjoy the benefits too.

Can I change the air conditioner my Sensibo Sky is paired to?

Yes – just select “Change Remote” in settings menu. If the WiFi network is different then it has to be re-set as well

Can I set up my Sensibo to trigger depending on the climate on the day?

Yes! Using the new ‘Climate React’ feature the user can set an automated reaction to room temperature when it rises or falls to a certain level. **For example**, you can have Sensibo Sky start up to cool at 25° if the room temperature gets above 30°

Alternatively a trigger point can be set using IFTTT (if this then that). You’ll need the free app ‘IFTTT’ and set up your own parameters. For example you can have Sensibo turn on and start heating if the outside temperature drops below a certain mark. The IFTTT app can even send you a notification to tell you it has activated!

Can I still use my existing remote?

Yes! Sensibo Sky will sync with the commands sent from the remote

Frequently asked questions – Physical unit



Does Sensibo Sky use batteries?

No. It powers through the supplied micro USB connection to mains power.

What is the other port on the back of the Sensibo Sky unit?

It's a piggy back for possible future add-ons, like motion or heat sensors

How long is the power cord?

It is 1m in length.

What does the light on the front do?

When connected the Sky unit does not light up at all, you will see one blink from the light when a command is sent via the app. Outside of this there is a sequence of light flashes that indicate and issues eg: 2 fast blinks means Sensibo is in set-up mode.

Frequently asked questions – Support

Help! What about support?

Email support is available 24/7 you can even seek support straight from the app. There is a pile of how-to guides and video's on the Sensibo.co.nz website.

Warranty

Sensibo Sky is covered by a 12 month warranty.



Specifications



PRODUCT COPY

BRAND: SENSIBO

MODEL: SENSIBO SKY

WIFI AIR CONDITIONER CONTROLLER

BRIEF PRODUCT FEATURE DESCRIPTION (IN ORDER OF IMPORTANCE)

Control your air conditioner from anywhere, anytime

Save money, lower power bills

Monitor temperature & humidity remotely

Automatically turn on or off based on your location

Works on any remote-controlled air conditioner

Easy 7-day scheduling

Connect to Google Home

Turn on your air conditioner before you get home

Share control with family and friends

Monitor and react to climate changes

PC interface

Easy set up

REQUIREMENTS

You will need: Download free app, WiFi network with internet connection, a smart phone (iPhone or android), any infrared remote-controlled air conditioner (split, portable or window type)

WARRANTY

Warranty: 12 months parts and labour

PRODUCT SPECS

MODEL: SENSIBO SKY

TYPE: WiFi controller for air conditioners

Dimensions (Sky unit): 5.5 x 8.3 x 2 cm (L x H x D)

Weight (Sky unit): 43 gr

Power: AC Power: micro USB (supplied adapter)

Barcode: 7290016037098

WHAT'S IN THE BOX

Sensibo Sky Hub

1m micro USB cable

AC Power adapter

USER GUIDES

Available online or request through app

BRAND & CORPORATE DETAIL

AppliancePro Pty., Limited

www.appliancepro.com.au/sensibo

www.appliancepro.co.nz/sensibo

